

SINGLE PHASE VOLTAGE TRANSFORMERS

TPN SERIES



TPN96



TPN96 - open terminal lid

- **For indoor, outdoor and wet environments**
- **Primary voltage up to 1200V**
- **Measurement and protection**
- **Tropicalized**

Voltage transformers for the measurement of AC voltages up to 1200 V for industrial and marine applications.

The terminals are protected to prevent accidental contact with live parts.

Fixing holes incorporated to the transformer body allow its installation in any position.

Technical data

Rated insulation	0.72/3 kV
Primary voltage	10 to 400 V
Secondary voltage	100 / $\sqrt{3}$ - 110 / $\sqrt{3}$ - 100 - 110 V
Frequency	50 or 60 Hz
Rated output	5 VA to 80 VA
Accuracy class	0.2 - 0.5 - 1 - 3 - cl A
Thermal power	Up to 250 VA
Voltage factor	1.2 Un permanent
Insulation class	E
Live terminal	Terminal blocks with screw connectors
Earth terminal	Terminal block with screw connectors
Terminal protection	IP40 with cover lid
Rated output	-25°C to + 40°C
Norm	IEC - IEEE - CSA - AS - BS

Autres caractéristiques sur demande

Rated insulation	Up to 1.2/6 kV
Primary voltage	10 to 1200 V
Secondary voltage	10 to 1200 V
Thermal power	Up to 100VA
Accuracy class	0.2 – 3P – 6P
Rated output	- 25°C to + 70°C
Winding taps	Up to 3 primary and/or secondary taps
Separate secondary windings	Up to 2 secondary windings
Terminal protection cover lid + seal	IP54

Accessories / Options

- Sealable terminal cover lid
- Primary/Secondary shield
- Protection of primary and secondary connection cables through cable glands

SINGLE PHASE VOLTAGE TRANSFORMERS - TPN SERIES

Selection table

Type	Burden maximum in VA				Thermal output maximum in VA	Weight Approximate
	cl 3	cl 1	cl 0.5	cl 0.2		
TPN96	60	20	15	5	75	4kg
TPN120	200	100	50	15	250	6kg

TPN96

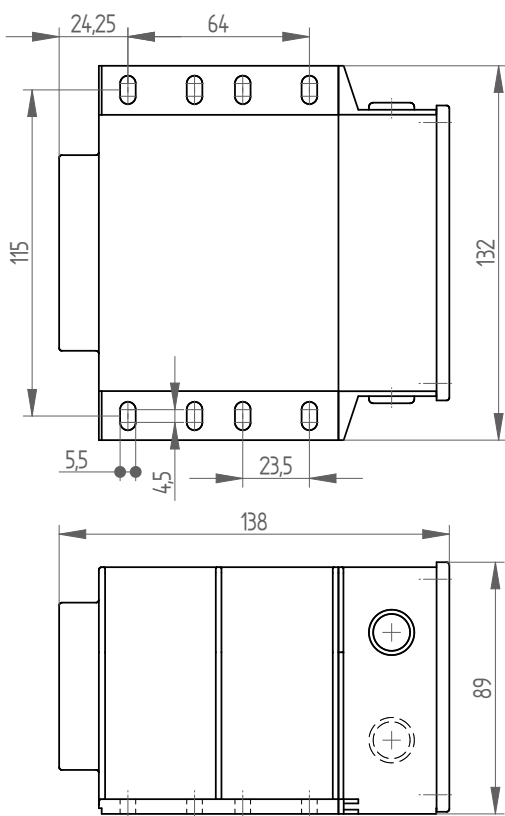

TPN120

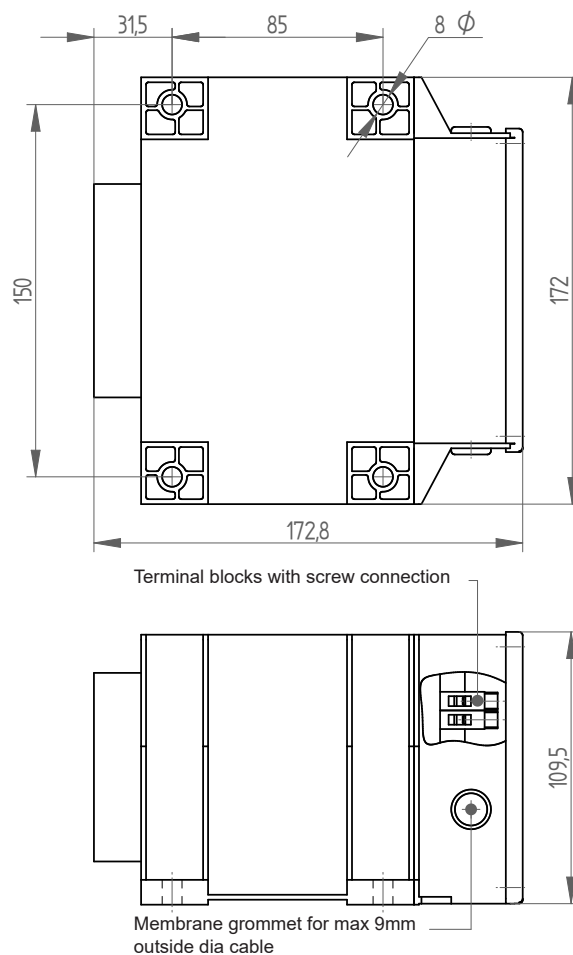

Installation

Connections to terminal blocks with screw connectors :

- Solid conductor min 0.2 mm²
- Solid conductor max 6 mm²
- Stranded conductor min 0.2 mm²
- Stranded conductor max: 6 mm²
- Conductor Stripping length : 8 mm
- Thread of the terminal blocks clamping screw: M3
- Torque: 0.6 to 0.8 Nm

Marking :

Primary : A-B Phase - Phase
A-N Phase - Ground

Secondary : a-b Phase- Phase
a-n Phase - Ground
da-dn Tertiary winding